

DOCUMENTS on DEPOSIT



**These documents should remain
available for public inspection
until 4 January 2021**

In the Borough of Swale

**THE KENT COUNTY COUNCIL
(VARIOUS ROADS, BOROUGH OF SWALE)
(WAITING RESTRICTIONS AND STREET PARKING PLACES)
(AMENDMENT No.17) ORDER 2020**

Road Traffic Regulation Act 1984

Please return to:

Schemes Planning and Delivery Team

Kent County Council Highways, Transportation & Waste

Ashford Highway Depot

Javelin Way

Ashford

TN24 8AD

PUBLIC NOTICE



In the Borough of Swale

THE KENT COUNTY COUNCIL (VARIOUS ROADS, BOROUGH OF SWALE) (WAITING RESTRICTIONS AND STREET PARKING PLACES) (AMENDMENT No.17) ORDER 2020 Road Traffic Regulation Act 1984

Notice is hereby given that KENT COUNTY COUNCIL under sections 1(1), 2 (1) to (3), 3 (2), 4 (1) and (2), 32 (1), 35 (1), 44, 45, 46, 49 and 53 of the Road Traffic Regulation Act 1984 (hereinafter called "the Act") and of all other enabling powers, and after consultation with the chief officer of police in accordance with Paragraph 20 of Schedule 9 to the Act, hereby make the following order:-

The effect of the made named Order will be to install waiting restrictions in the following lengths of road (in this part of the notice DYL's means double yellow lines) waiting to be prohibited at any time.

Roads in Sittingbourne in the Borough of Swale

FOUNTAIN STREET – To remove the single yellow lines and replace them with double yellow lines on both sides for its entire length. **STATION STREET** – (1) To change the DYL to both sides from its junction with St Michael's Road for its entire length. (2) To change the DYL on the east side from its junction with High Street for its entire length. **ST MICHAEL'S ROAD** – (1) To change the DYL entry on the western side to include both sides of the access road to the car park. (2) To change the DYL entry on the eastern side to a point 12 metres east of its junction with Station Street. (3) To change the DYL entry on the northern side from a point 71 metres east of east boundary of Kwik Fit for a distance of 14 metres in an easterly direction and to **remove the Time Limited area for Buses between 8am and 6pm Mon-Sat** on the north side opposite and between both junctions of Station Street. (4) **To change the length of the 1 Hour Time Limited Bays** by 37 metres. **ST MICHAEL'S ROAD (SERVICE ROAD/LAYBY)** – (1) To place DYL on both sides for its entire length. (2) **To add a Goods Loading bay at any time** on the north side from a point opposite and in line with the western building line of 9 The Forum for a distance of 28 metres in an easterly direction. **THE FORUM** – To change the DYL entry to on both sides for its entire length.

The Order was made on 19 November 2020 and its provisions will come into effect on 23 November 2020.

A copy of the Order, statement of the Council's reasons for making the Order, a map indicating the location and the effect and a copy of any Orders which will be amended by the Order may be examined Monday to Friday at The Kent County Council, Sessions House, Maidstone, ME14 1XQ and at Highways, Transportation & Waste, Ashford Highway Depot, Henwood Industrial Estate, Unit 4 Javelin Way, Ashford, Kent TN24 8AD during normal office hours or viewed online at www.kent.gov.uk/highwaysconsultations

Anyone may, by application to the High Court within 6 weeks of the date of publication of this Notice, challenge the validity of the Orders or of any provision contained in them on the grounds that it is not within the powers conferred by the Road Traffic Regulation Act 1984, or any instrument made thereunder, or that there has been a failure to comply with any statutory requirement to the Orders.

Simon Jones Director of Highways, Transportation and Waste

STATEMENT of REASON



In the Borough of Swale

THE KENT COUNTY COUNCIL
(VARIOUS ROADS, BOROUGH OF SWALE)
(WAITING RESTRICTIONS AND STREET PARKING PLACES)
(AMENDMENT No.17) ORDER 2020
Road Traffic Regulation Act 1984

The Kent County Council acting as the Local Traffic Authority hereby make the Order referred to above and as shown on the drawings accompanying this document in the interest of public safety due to the new Spirit of Sittingbourne development.

- **for avoiding danger to persons or other traffic using the road or any other road of for preventing the likelihood of any such danger arising.**
- **for preserving or improving the amenities of the area through which the road runs.**
- **for facilitating the passage on the road or any other road of any class of traffic (including pedestrians).**

Nikola Floodgate

Schemes Planning and Delivery Manager
Highways, Transportation & Waste

THE KENT COUNTY COUNCIL
(VARIOUS ROADS, BOROUGH OF SWALE)
(WAITING RESTRICTIONS AND STREET PARKING PLACES)
(AMENDMENT No.17)
ORDER 2020

The Kent County Council, acting as the Local Traffic Authority and in exercise of its powers and under Sections 1(1), 2(1) to (3), 3(2), 4(1) and (2), 32(1), 35(1), 44, 45, 46, 49 and 53 of the Road Traffic Regulation Act 1984 ('the Act') and of all other enabling powers, and after consultation with the chief officer of police in accordance with Part III of Schedule 9 to the Act hereby make the following Order:-

A – This Order may be cited as “The Kent County Council (Various Roads, Borough of Swale) (Waiting Restrictions and Parking Places) Amendment No.17” ('this Order') and shall come into force on the 23rd day of November 2020.

B - “The Kent County Council (Various Roads, Borough of Swale) (Traffic Regulation and Street Parking Places) (Consolidation) Order 2019” ('the of Order 2019') shall have effect as though:

In the Schedules to the Order of 2019

Roads in Sittingbourne in the Borough of Swale

The following to be inserted to the First Schedule of the Order of 2019 in place of the existing entry:-

FOUNTAIN STREET

On both sides for its entire length.

The following to be inserted to the First Schedule of the Order of 2019 in place of the existing entries:-

STATION STREET (1) On both sides from its junction with St Michael's Road for its entire length.

(2) On the east side from the northern kerblines of High Street for its entire length.

(3) On the west side

(a) from the northern kerblines of High Street, north to a point 5 metres north of the southern building wall of 2 Station Street;

(b) from a point 43 metres north of the northern kerblines of High Street to a point in line with the boundary of 23/25 Station Street including the turning head.

The following to be inserted into the First Schedule of the Order of 2019 in correct alphabetical sequence:

ST MICHAEL'S ROAD (SERVICE ROAD/LAYBY)

On both sides for its entire length.

The following to be inserted to the First Schedule of the Order of 2019 in place of the existing entries:-

ST MICHAEL'S ROAD (1) On the western side and northern side from the junction with West Street to a point 10 metres west of the western building line of St Michael's House (including both sides of the Car Park access road).

(2) On the eastern side and southern side from its junction with West Street to a point 12 metres east of the eastern kerblines of Station Street (eastern end).

(3) On the southern side from its junction with The Butts to the junction with East Street.

(4) On the northern side

(a) from a point 71 metres east of the east boundary of Kwik Fit for a distance of 14 metres in an easterly direction;

(b) from a point in line with the boundary of St. Michael's Garage/Fire Station to the Junction with East Street.

The following to be inserted to the First Schedule of the Order of 2019 in place of the existing entry:-

THE FORUM On both sides for its entire length.

The following to be inserted to the Sixth Schedule of the Order of 2019 in place the existing entry:

Limited Waiting Monday to Saturday 8.00am to 6.00pm 1 hours no return for 2 hours.

ST MICHAEL'S ROAD

On the northern side from a point 85 meters east of the east boundary of Kwik Fit for a distance of 28 metres in an easterly direction.

Loading Bay for Goods Vehicles

The following item to be added to the Table (Article 24 (3)) in Part F of the Order of 2019 in correct order:-

1	2	3	4	5
Item	Name of Road	Length of Road	Days on which restriction applies	Times at which restriction applies
5	ST MICHAEL'S ROAD (SERVICE ROAD/LAYBY)	On the north side from a point in opposite and in line with the western building line of 9 The Forum for a distance of 28 metres in an easterly direction.	Daily	At all times

The following entry to be removed from the Sixth Schedule Part 2 of the Order of 2019:

STREET OR LENGTH OF STREET WHERE PARKING IS LIMITED TO BUSES FOR A
MAXIMUM OF 2 HOURS BETWEEN THE HOURS OF 8.00AM AND 6.00PM MONDAYS
TO SATURDAYS (WITH NO RETURN WITHIN 1 HOUR SINCE THE LAST PERIOD OF
PERMITTED WAITING)

ST MICHAEL'S ROAD

On the north side, from a point 21 metres west of the centre of the
Station Street Junction to a point 10 metres east of the centre of the
Station Street Junction.

The following entries to be removed from the Third Schedule of the Order of 2019:

FOUNTAIN STREET On both sides

(a) from a point 22 metres west of the western kerblines of the northern
arm (formerly Pembury Street) and across closed end;

(b) for the entire length of the northern arm (formerly Pembury Street)
and across closed end.

Given under the Common Seal of the Kent County Council

This day of 2020.

THE COMMON SEAL OF THE
KENT COUNTY COUNCIL was
hereunto affixed in the
presence of: -

Authorised Signatory

A1

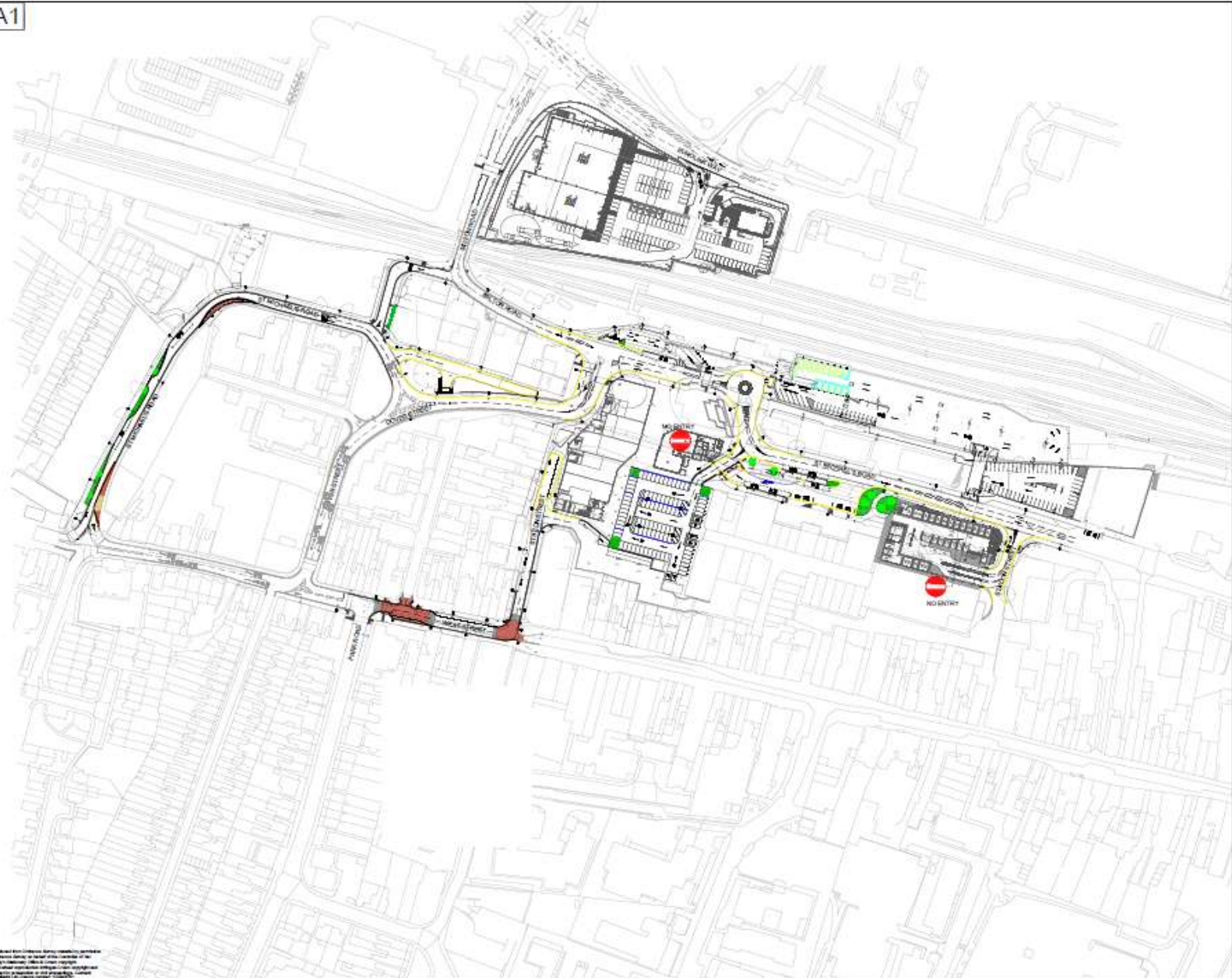

Reproduced from Ordnance Survey maps. Ordnance Survey is the copyright owner of the map data. All rights reserved. Ordnance Survey is not responsible for any errors or omissions in the map data. The map data is provided as a guide only and should not be used for navigation purposes.

KEY
 --- PROPOSED DOUBLE YELLOW LINES
 --- PROPOSED LOADING BAY

DATE	APPROVED	BY	DATE
 TERMINAL STREET, SITTINGBOURNE, BRISTOL, BS27 8AG Tel: 01843 252255 Fax: 01843 252266 Web: www.connect-consultants.com Email: info@connect-consultants.com			
CLIENT SPIRIT OF SITTINGBOURNE LLP			
PROJECT PROPOSED DEVELOPMENT SITTINGBOURNE			
SCALE 1:1000	DRAWN BY S.G.J.	CHECKED BY C.B.W.	
DATE JULY 2020	FILE NO 1502-TRO-005.dwg		
TITLE TRAFFIC REGULATION ORDERS GENERAL ARRANGEMENT			
PROJECT NO 15025-1000			